

# PRESTO

PARTS AND INSTRUCTION SHEET FOR

## MOST SANITARY TYPE 316 STAINLESS STEEL LEVER TYPE INJECTION VALVES

U.S.D.A./ACCEPTED



ORDER BY PART NUMBERS AND NAMES TO INSURE PROMPT AND ACCURATE SHIPMENT OF ORDERS. ALL ORDERS SHIPPED IMMEDIATELY FROM STOCK.

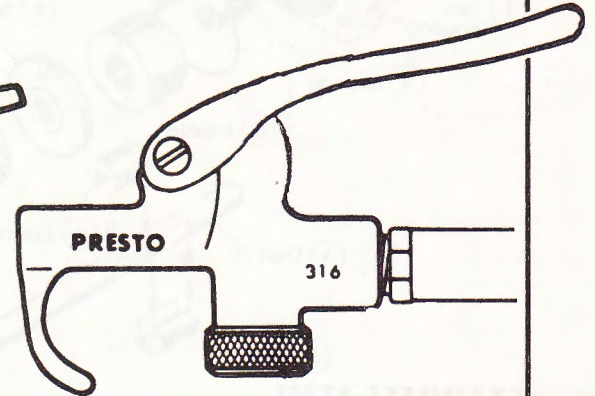
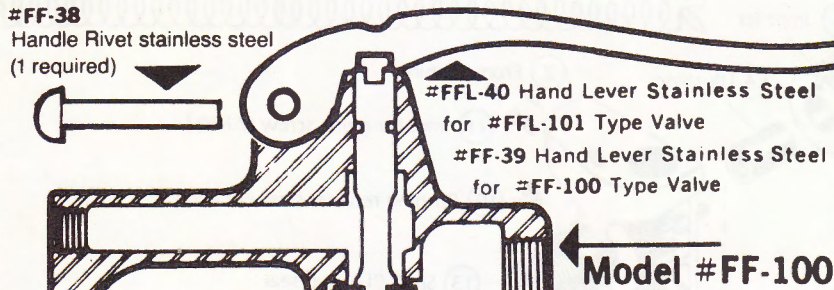

### INSTRUCTIONS:

To assemble use the same sequence as shown at left.

Clean hand valve with clean warm water after each days operation for more sanitary and trouble-free injection.

### IMPORTANT

Internal parts fit both valve bodies and all metal parts are made of sanitary stainless steel.

**Please file** for ready reference and accurate ordering.

Distributed by:

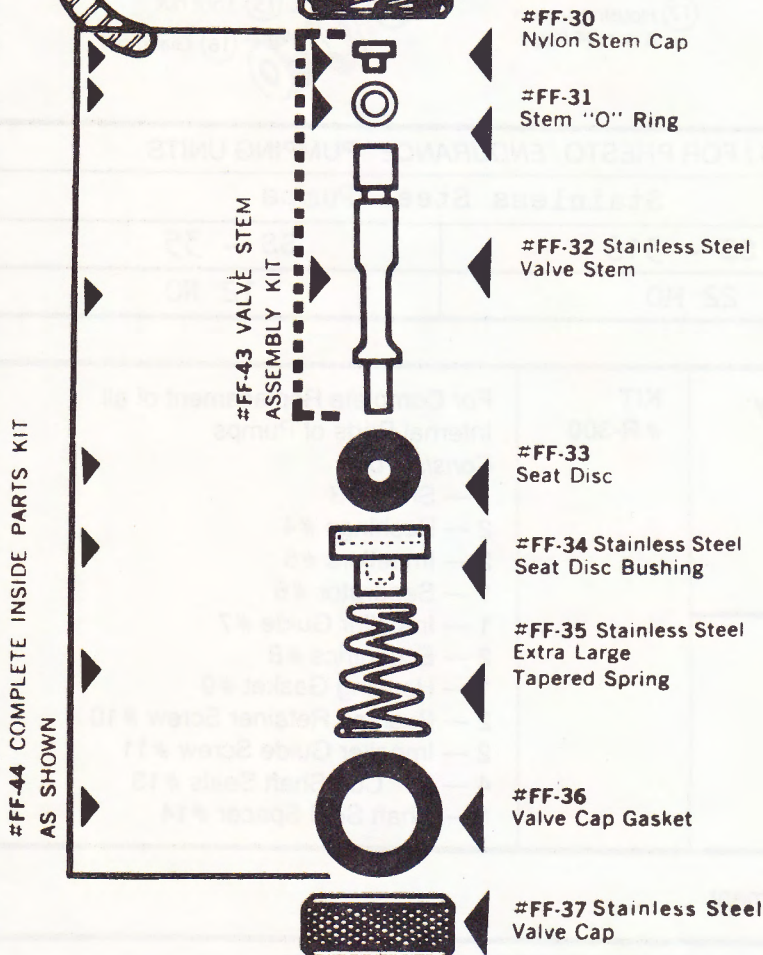

SPECIFICATIONS AND PRICES SUBJECT TO CHANGE WITHOUT NOTICE